

# Centerstate Logistics Park

±480,939 SF

8565 State Road 33  
Lakeland, FL 33809



<b>Total SF</b>	±1,011,697 SF
<b>Available SF</b>	±480,939 SF
<b>Parcel size</b>	164.85 acres
<b>Office SF</b>	±3,318 SF
<b>Building Dimensions</b>	2,000'(W) x 500'(D)
<b>Column Spacing</b>	56'(W) x 54'3"(D), 60' speed bay
<b>Frontage</b>	5,100' linear feet on I-4
<b>Clear Height</b>	40'
<b>Roof</b>	White 60 mil TPO membrane over R-20 rigid insulation
<b>Loading Type</b>	Cross-dock
<b>Dock-High/Drive-In Doors</b>	131/2

<b>Truck Court Depth</b>	190'
<b>Warehouse Lighting</b>	LED
<b>Fire Protection</b>	ESFR
<b>Power</b>	6,400A, 480/277V, 3-phase
<b>Auto/Truck Parking</b>	253(expandable)/142
<b>Slab Design</b>	Slab on grade, 7", 4,000 psi
<b>Zoning</b>	PUD Industrial, City of Lakeland
<b>Year Built</b>	2021
<b>Windows</b>	Clerestory north and south elevations
<b>Construction</b>	Concrete tilt-wall

8565 State Road 33  
Lakeland, FL 33809

For Lease

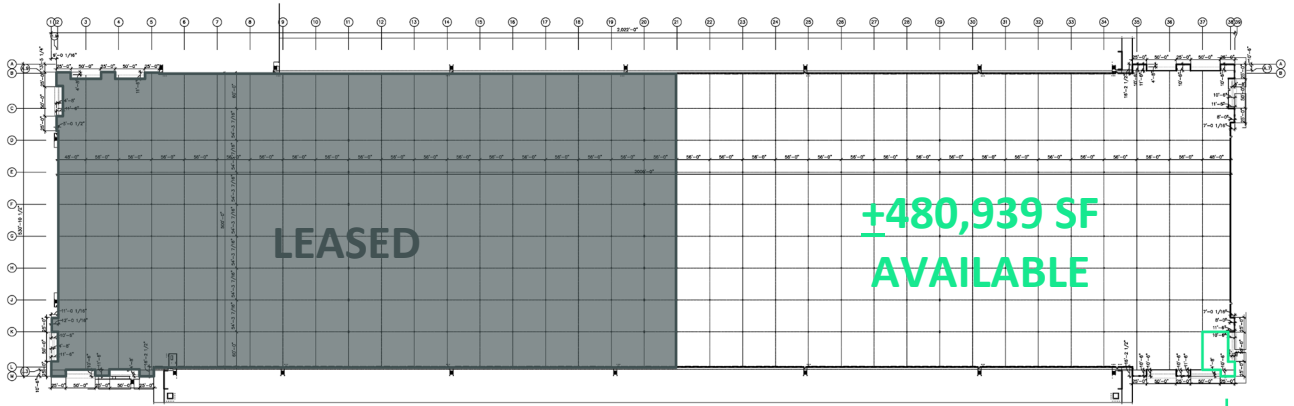

+3,318 SF Spec Office

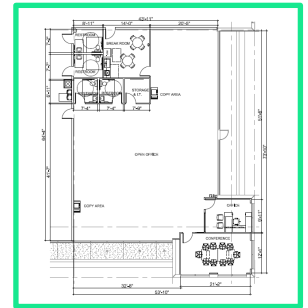

## Contact us

### LEASED BY:

JLL

**John C. Dunphy, CCIM, SIOR**

Executive Managing Director

+1 813 387 1312

[Johnc.Dunphy@jll.com](mailto:Johnc.Dunphy@jll.com)

**Peter Cecora, SIOR**

Managing Director

+1 813 387 1297

[Peter.Cecora@jll.com](mailto:Peter.Cecora@jll.com)

### OWNED BY:

**CBRE Investment Management**

**Benjamin Hoog**

Asset Manager

+1 314 435 4217

[Benjamin.Hoog@cbreim.com](mailto:Benjamin.Hoog@cbreim.com)

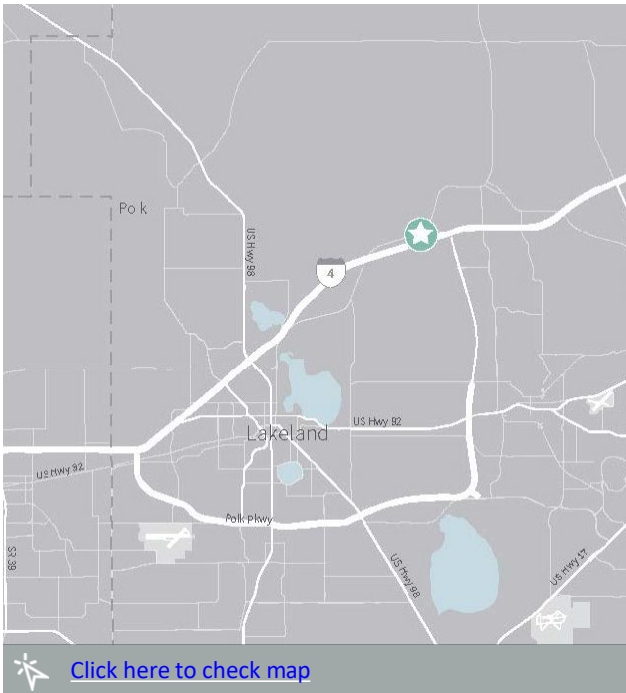

© 2023 CBRE, Inc. All rights reserved. This information has been obtained from sources believed reliable, but has not been verified for accuracy or completeness. You should conduct a careful, independent investigation of the property and verify all information. Any reliance on this information is solely at your own risk. CBRE and the CBRE logo are service marks of CBRE, Inc. All other marks displayed on this document are the property of their respective owners, and the use of such logos does not imply any affiliation with or endorsement of CBRE. Photos herein are the property of their respective owners. Use of these images without the express written consent of the owner is prohibited.